

OKLAHOMA DEPARTMENT OF TRANSPORTATION					
FED. ROAD DIST. NO.	STATE	JOB PIECE NO.	FISCAL YEAR	SHEET NO.	TOTAL SHEETS
6	OKLA.				
REVISIONS		DESCRIPTION	DATE		
▲		OMITTED BRIDGE 'G'	8/15/16		

STATE OF OKLAHOMA
DEPARTMENT OF TRANSPORTATION

PLAN OF PROPOSED
STATE HIGHWAY

DIVISION 3 BRIDGE DRIFT/DEBRIS REMOVAL
FEDERAL AID PROJECT NO. STP-263F(041)3B
STATE JOB NO. 31379(04)

INDEX OF SHEETS

NO.	TITLE
1.	TITLE SHEET
AB01.	GENERAL NOTES AND SUMMARY OF PAY QUANTITIES
B001.	LAYOUT OF DRIFTWOOD REMOVAL - BRIDGE 'A'
B002.	LAYOUT OF DRIFTWOOD REMOVAL - BRIDGE 'B'
B003.	LAYOUT OF DRIFTWOOD REMOVAL - BRIDGE 'C'
B004.	LAYOUT OF DRIFTWOOD REMOVAL - BRIDGE 'D'
B005.	LAYOUT OF DRIFTWOOD REMOVAL - BRIDGE 'E'
B006.	LAYOUT OF DRIFTWOOD REMOVAL - BRIDGE 'F'
▲ B007.	(OMITTED)
B008.	LAYOUT OF DRIFTWOOD REMOVAL - BRIDGE 'H'
B009.	LAYOUT OF DRIFTWOOD REMOVAL - BRIDGE 'I'
B010.	LAYOUT OF DRIFTWOOD REMOVAL - BRIDGE 'J'

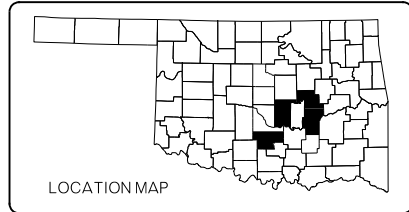

BRIDGE DESIGN

PROJECT ENGINEER: R. SISON, P.E.
ASSISTANT SQUAD SUPERVISOR: B. BROWN
SQUAD MEMBERS: C. ANGER, M. JOHNSON, J. CONWAY, B. BOLES
D. RAYBURN, D. VAUGHAN, P. HIEMSTRA

CONVENTIONAL SYMBOLS

- PROPOSED ROAD
- RAILROADS
- RANGE & TOWNSHIP
- SECTION LINES
- QUARTER SECTION LINES
- FENCES
- GROUND LINE
- EXISTING ROADS
- BASE LINE
- GRADE LINES
- TELEPHONE & TELEGRAPH
- POWER LINES
- BUILDINGS
- OIL WELL
- DRAINAGE STRUCTURES - IN PLACE
- DRAINAGE STRUCTURES - NEW
- RIGHT-OF-WAY LINES - EXISTING
- RIGHT-OF-WAY LINES - NEW
- CONTROLLED ACCESS
- RIGHT-OF-WAY FENCE

2009 OKLAHOMA STANDARD SPECIFICATIONS FOR HIGHWAY CONSTRUCTION GOVERN, APPROVED BY THE U.S. DEPARTMENT OF TRANSPORTATION, FEDERAL HIGHWAY ADMINISTRATION, JANUARY 4, 2010.

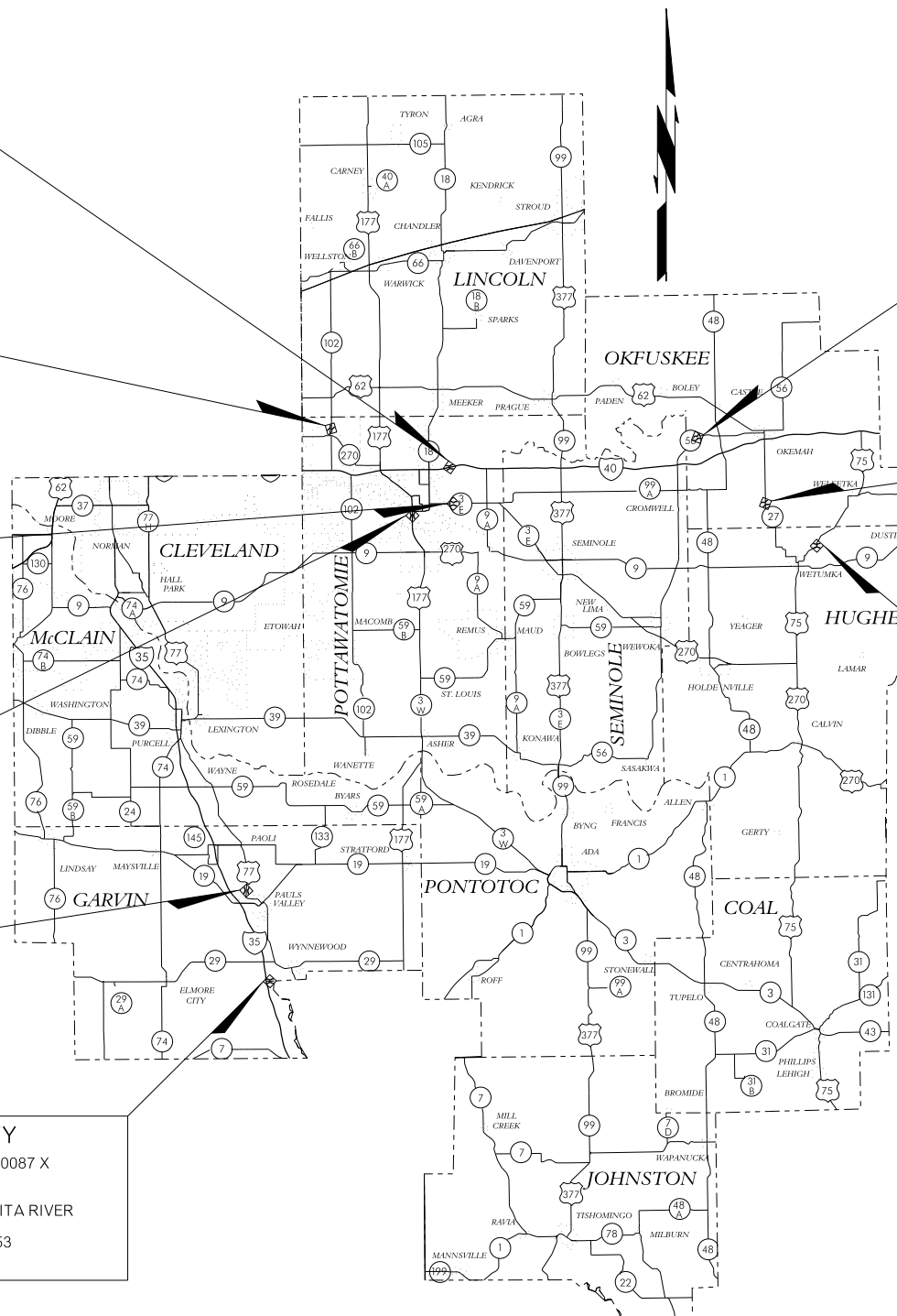

POTTAWATOMIE COUNTY
BRIDGE 'B' - LOCATION NO. 6341 0269 SX
NBI NO. 15865
FACILITY CARRIED: I-40 EB
FEATURES INTERSECTED: N CANADIAN RIVER
LOCATION: 2.8 MI E JCT SH 18
CONTROL SECTION NO. 40-63-41
SEC. NO. 34 T-11-N R-4-E

POTTAWATOMIE COUNTY
BRIDGE 'J' - LOCATION NO. 6356 0070 X
NBI NO. 30017
FACILITY CARRIED: SH-102
FEATURES INTERSECTED: N CANADIAN RIVER
LOCATION: 0.7 N OF JCT US 270
CONTROL SECTION NO. 102-63-56
SEC. NO. 9 T-11-N R-2-E

POTTAWATOMIE COUNTY
BRIDGE 'I' - LOCATION NO. 6304 0227 X
NBI NO. 19276
FACILITY CARRIED: SH-3E
FEATURES INTERSECTED: N CANADIAN RIVER
LOCATION: 2.2 MI E JCT SH 18
CONTROL SECTION NO. 03E-63-04
SEC. NO. 22 T-10-N R-4-E

POTTAWATOMIE COUNTY
BRIDGE 'A' - LOCATION NO. 6323 0620 X
NBI NO. 15388
FACILITY CARRIED: US-270
FEATURES INTERSECTED: N CANADIAN RIVER
LOCATION: 3.9 MI S JCT SH 3
CONTROL SECTION NO. 270-63-23
SEC. NO. 25 T-10-N R-3-E

GARVIN COUNTY
BRIDGE 'D' - LOCATION NO. 2502 1239 X
NBI NO. 16814
FACILITY CARRIED: US-77
FEATURES INTERSECTED: WASHITA RIVER
LOCATION: 5.3 MI S PAOLI
CONTROL SECTION NO. 77-25-02
SEC. NO. 1 T-3-N R-1-W

GARVIN COUNTY
BRIDGE 'H' - LOCATION NO. 2553 0087 X
NBI NO. 17956
FACILITY CARRIED: SH-17A
FEATURES INTERSECTED: WASHITA RIVER
LOCATION: 0.8 MI E I-35
CONTROL SECTION NO. 17A-25-53
SEC. NO. 28 T-2-N R-1-E

OKFUSKEE COUNTY
BRIDGE 'E' - LOCATION NO. 5414 0233 X
NBI NO. 22686
FACILITY CARRIED: SH-56
FEATURES INTERSECTED: N. CANADIAN RIVER
LOCATION: 2.5 MI E SEMINOLE CO
CONTROL SECTION NO. 56-54-14
SEC. NO. 13 T-11-N R-8-E

OKFUSKEE COUNTY
BRIDGE 'C' - LOCATION NO. 5408 0398 X
NBI NO. 28619
FACILITY CARRIED: SH-27
FEATURES INTERSECTED: N. CANADIAN RIVER
LOCATION: 4.2 NW HUGHES C/L
CONTROL SECTION NO. 27-54-08
SEC. NO. 19 T-10-N R-10-E

HUGHES COUNTY
BRIDGE 'F' - LOCATION NO. 3204 2190 X
NBI NO. 21128
FACILITY CARRIED: US-75
FEATURES INTERSECTED: N. CANADIAN RIVER
LOCATION: 2.9 S OKFUSKEE C/L
CONTROL SECTION NO. 75-32-04
SEC. NO. 12 T-9-N R-10-E

PREPARED BY:
OKLAHOMA DEPARTMENT OF TRANSPORTATION
BRIDGE DESIGN DIVISION
Roland D. Sison
ROLAND D. SISON
R. SISON, P.E.
OKLA. REG. NO. 23082
DATE: 8-15-16

OKLAHOMA DEPARTMENT OF TRANSPORTATION	DEPARTMENT OF TRANSPORTATION FEDERAL HIGHWAY ADMINISTRATION
DATE APPROVED _____	DATE APPROVED _____
BY _____ CHIEF ENGINEER	BY _____ DIVISION ADMINISTRATOR
SWO _____	PROJECT NO. STP-263F(041)3B
COUNTY MULTIPLE	HIGHWAY MULTIPLE SHEET NO. 1

P.E. NO. : 23285(01)

GENERAL NOTES

SPECIFICATIONS:

COMPLY WITH THE REQUIREMENTS OF THE 2009 STANDARD SPECIFICATIONS FOR HIGHWAY CONSTRUCTION, EXCEPT AS MODIFIED BY THE PLANS AND SPECIAL PROVISIONS.

SCOPE:

THIS PROJECT CONSISTS OF THE REMOVAL OF DRIFTWOOD THAT HAS COLLECTED AGAINST THE BRIDGE PIER COLUMNS.

THE PRICE BID WILL INCLUDE ALL LABOR, MATERIALS AND EQUIPMENT NECESSARY TO PERFORM THE WORK AS DESCRIBED IN THE PLANS. THE DEPARTMENT MAY CHOOSE TO HAVE THE CONTRACTOR PREFORM ALL, SOME OR NONE OF THE ADD ALTERNATES ON THIS CONTRACT.

VERIFICATION OF EXISTING CONDITIONS:

ALL DIMENSIONS OF THE PROJECT SHOWN ON THE PLANS ARE APPROXIMATE. THE CONTRACTOR SHALL VERIFY ALL DIMENSIONS NECESSARY TO CONSTRUCT THE PROJECT AND SHALL BE SOLELY RESPONSIBLE FOR THE ACCURACY THEREOF. BIDDERS SHALL FULLY INFORM THEMSELVES OF THE NATURE OF THE WORK AND CONDITIONS UNDER WHICH IT WILL BE PERFORMED.

THE CONTRACTOR SHALL ADOPT METHODS CONSISTENT WITH GOOD CONSTRUCTION PRACTICE AND SHALL TAKE ALL NECESSARY PRECAUTIONS TO PREVENT DAMAGE TO ANY EXISTING BRIDGE STRUCTURE OR ROADWAY. ANY DAMAGE TO THE BRIDGE STRUCTURE OR ROADWAY DUE TO THE CONTRACTOR'S NEGLIGENCE SHALL BE REPAIRED AT THE CONTRACTOR'S EXPENSE, TO THE SATISFACTION OF THE ENGINEER. THERE SHALL BE NO CHANNEL EXCAVATION.

REMOVAL OF DRIFTWOOD:

REMOVE ALL DRIFT AND DEBRIS IN THE AREAS SHOWN IN THE PLANS AND ALL OTHER DRIFT AND DEBRIS WITHIN THE LIMITS OF THE RIGHT-OF-WAY AS DIRECTED BY THE ENGINEER. THE DRIFT AND DEBRIS SHALL BE REMOVED IN A MANNER APPROVED BY THE ENGINEER. ALL DEBRIS SHALL BE REMOVED FROM THE CREEK BANK AND SHALL NOT BE REMOVED FROM THE BRIDGE DECK. THERE SHALL NOT BE ANY EQUIPMENT ALLOWED ON THE BRIDGE DURING THE REMOVAL PROCESS.

THE APPROXIMATE QUANTITIES WERE OBSERVED AT THE FIELD INSPECTION AND COULD VARY GREATLY AT THE TIME WORK BEGINS ON THIS PROJECT. THE BIDDERS SHOULD INFORM THEMSELVES AS TO THE CONDITIONS AT THE TIME OF BID SUBMISSIONS.

ALL REMOVED MATERIAL SHALL BE DISPOSED OF BEYOND THE CHANNEL, IN AN AREA OUTSIDE OF THE RIGHT-OF-WAY, IN A MANNER APPROVED BY THE ENGINEER. THE DRIFT AND DEBRIS SHALL NOT BE BURNED WITHIN THE LIMITS OF THE RIGHT-OF-WAY AND THE DISPOSAL SHALL IN NO WAY IMPEDE OR ENDANGER THE PUBLIC. THE DEBRIS SHALL NOT BE ALLOWED TO BE LEFT IN THE CHANNEL TO FLOW DOWNSTREAM.

ALL COSTS INCLUDING EQUIPMENT, LABOR, MATERIAL, AND INCIDENTALS NECESSARY TO COMPLETE THE WORK AS DESCRIBED ABOVE SHALL BE INCLUDED IN THE PRICE BID PER LUMP SUM OF "REMOVE DRIFT AND SILT".

TEMPORARY WORK ROADS:

CONTRACTOR MAY CONSTRUCT TEMPORARY WORK ROADS OR PADS AS NEEDED TO PERFORM THE WORK. UPON COMPLETION OF DRIFT REMOVAL THE CONTRACTOR WILL REMOVE TEMPORARY ROADS AND PADS RESTORING THE RIGHT-OF-WAY TO THE ORIGINAL CONDITION PRIOR TO CONSTRUCTION AT THE DISCRETION OF THE ENGINEER. ALL COSTS TO BE INCLUDED IN LUMP SUM PRICE BID FOR DRIFT REMOVAL.

ENVIRONMENTAL MITIGATION NOTES:

BALD EAGLE:

IF CONSTRUCTION ACTIVITIES ARE NOT COMPLETED BY DECEMBER 1, 2016 THE RESIDENT ENGINEER SHALL CONTACT THE ODOT BIOLOGIST AT (405) 521-2515. THE ODOT BIOLOGIST SHALL SCHEDULE AN ADDITIONAL SURVEY DURING DECEMBER AND JANUARY. IF THE SURVEY IS POSITIVE FOR A BALD EAGLE NEST, NO WORK WILL BE ALLOWED WITHIN 660 FEET OF THE NEST DURING THE NESTING SEASON (DECEMBER 1 THROUGH MAY 31), IN ACCORDANCE WITH THE NATIONAL BALD EAGLE MANAGEMENT GUIDELINES. IF THE BUFFER CANNOT BE MAINTAINED, ALL CLEARING, CONSTRUCTION AND LANDSCAPING ACTIVITIES WITHIN 660 FEET OF THE NEST SHALL BE CONDUCTED BETWEEN JUNE 1 AND NOVEMBER 30, OUTSIDE THE NESTING SEASON.

AMERICAN BURYING BEETLE:

THE AMERICAN BURYING BEETLE IS A LARGE CARRION BURYING BEETLE THAT IS LISTED AS ENDANGERED UNDER THE ENDANGERED SPECIES ACT. IN ORDER TO AVOID ADVERSE IMPACTS, NO ARTIFICIAL LIGHTING SHALL BE USED DURING CONSTRUCTION. CARCASSES AND ALL FOOD TRASH SHALL BE REMOVED FROM THE PERMANENT AND TEMPORARY RIGHT-OF-WAY THROUGHOUT PROJECT ACTIVITIES.

MIGRATORY BIRDS:

MIGRATORY BIRDS ARE PROTECTED BY THE FEDERAL MIGRATORY BIRD TREATY ACT. THESE BIRDS COMMONLY USE BRIDGES AND CULVERTS FOR NESTING. THE NESTING SEASON FOR THE BIRDS RUNS FROM APRIL 1 TO AUGUST 31. ANY ACTIVITIES WHICH WOULD DESTROY ACTIVE NESTS OR HARM EGGS OR BIRDS WOULD VIOLATE THE MIGRATORY BIRD TREATY ACT. MIGRATORY BIRD USE OF BRIDGE NBI#S 15388, 15865, 28619, 16814, 22686, 21228, 17956, 19276, AND 30017 HAS BEEN OBSERVED DURING THE INITIAL SURVEY CONDUCTED AS PART OF THE BIOLOGICAL STUDIES IN 2016. MIGRATORY BIRD USE OF THE REMAINING BRIDGES AND CULVERTS WAS NOT OBSERVED DURING THE INITIAL SURVEY. MIGRATORY BIRDS MAY OCCUPY THESE STRUCTURES IN THE FUTURE NESTING SEASONS. THE RESIDENT ENGINEER WILL EVALUATE THE CONTRACTOR'S PROPOSED WORK METHODS AND CONCLUDE WHETHER THE PROPOSED WORK WOULD POSE DISRUPTION TO ANY NESTING BIRDS BEFORE WORK NEAR THE STRUCTURE IS AUTHORIZED. IF THE PROPOSED WORK WILL HARM ANY NESTING BIRDS, THE BRIDGE MAY BE NETTED PRIOR TO APRIL 1 OR THE WORK DELAYED UNTIL THE NESTING SEASON IS COMPLETE. METHODS OTHER THAN NETTING MUST BE PRE-APPROVED BY THE ODOT BIOLOGIST.

AIRPORT/AIRFIELD NOTES:

THE FOLLOWING DRIFT/DEBRIS REMOVAL PROJECTS ARE LOCATED WITHIN 4 MILES OF AN AIRPORT/AIRFIELD. THIS ACTION MAY REQUIRE NOTIFYING THE FEDERAL AVIATION ADMINISTRATION (FAA) OF PROPOSED CONSTRUCTION VIA FAA FORM 7460-1 PRIOR TO CONSTRUCTION:

BRIDGE "A", NBI# 15388, US-270 OVER N. CANADIAN RIVER IN POTTAWATOMIE CO.; SHAWNEE MUNICIPAL AIRPORT
 BRIDGE "B", NBI# 15865, I-40 (E.B.) OVER N. CANADIAN RIVER IN POTTAWATOMIE CO.; SHAWNEE MUNICIPAL AIRPORT
 BRIDGE "D", NBI# 16814, US-77 OVER WASHITA RIVER IN GARVIN CO.; PAULS VALLEY MUNICIPAL AIRPORT
 BRIDGE "I", NBI# 19276, SH-3E OVER N. CANADIAN RIVER IN POTTAWATOMIE CO.; SHAWNEE MUNICIPAL AIRPORT

HAZARDOUS MATERIALS:

THE POTENTIAL EXISTS FOR STORM DEBRIS TO CONTAIN POTENTIALLY HAZARDOUS MATERIALS. PLEASE ADHERE TO STANDARD SPECIFICATION 107.15 AND MONITOR FOR ABNORMAL CONDITIONS SUCH AS:

- BARRELS, DRUMS, TANKS OR OTHER CHEMICAL CONTAINERS WITH REMAINING PRODUCT
- NOXIOUS ODORS EMANATING FROM THE DEBRIS, SOIL OR WATER
- EXCESSIVE HEAT OR SMOKE INDICATING A POSSIBLE CHEMICAL REACTION
- HEAVILY STAINED OR OILY DEBRIS, SOIL OR WATER
- ANY OTHER CONDITION THAT INDICATES A HAZARDOUS MATERIAL OR TOXIC WASTE

BASE BID			
31379(04) PAY QUANTITIES			
0200 BRIDGE 'A' - NBI 15388 - US-270 OVER NORTH CANADIAN RIVER			
ITEM	DESCRIPTION	UNIT	QUANTITY
201	6215 (PL) REMOVE DRIFT AND SILT	LSUM	1.00
31379(04) PAY QUANTITIES			
0201 BRIDGE 'B' - NBI 15865 - I-40 EB. OVER NORTH CANADIAN RIVER			
ITEM	DESCRIPTION	UNIT	QUANTITY
201	6215 (PL) REMOVE DRIFT AND SILT	LSUM	1.00
31379(04) PAY QUANTITIES			
0202 BRIDGE 'C' - NBI 28619 - SH-27 OVER N. CANADIAN RIVER			
ITEM	DESCRIPTION	UNIT	QUANTITY
201	6215 (PL) REMOVE DRIFT AND SILT	LSUM	1.00
31379(04) PAY QUANTITIES			
0203 BRIDGE 'D' - NBI 16814 - US-77 OVER WASHITA RIVER			
ITEM	DESCRIPTION	UNIT	QUANTITY
201	6215 (PL) REMOVE DRIFT AND SILT	LSUM	1.00
31379(04) PAY QUANTITIES			
0204 BRIDGE 'E' - NBI 22686 - SH-56 OVER NORTH CANADIAN RIVER			
ITEM	DESCRIPTION	UNIT	QUANTITY
201	6215 (PL) REMOVE DRIFT AND SILT	LSUM	1.00
31379(04) PAY QUANTITIES			
0640 CONSTRUCTION			
ITEM	DESCRIPTION	UNIT	QUANTITY
641	1399 MOBILIZATION	LSUM	1.00

BID BASE BID PLUS ALL ADD ALTERNATE

ADD ALTERNATE			
31379(04) PAY QUANTITIES			
0205 BRIDGE 'F' - NBI 21128 - US-75 OVER NORTH CANADIAN RIVER			
ITEM	DESCRIPTION	UNIT	QUANTITY
201	6215 (PL) REMOVE DRIFT AND SILT	LSUM	1.00
31379(04) PAY QUANTITIES			
0207 BRIDGE 'H' - NBI 17956 - SH-17A OVER WASHITA RIVER			
ITEM	DESCRIPTION	UNIT	QUANTITY
201	6215 (PL) REMOVE DRIFT AND SILT	LSUM	1.00
31379(04) PAY QUANTITIES			
0208 BRIDGE 'I' - NBI 19276 - SH-3E OVER NORTH CANADIAN RIVER			
ITEM	DESCRIPTION	UNIT	QUANTITY
201	6215 (PL) REMOVE DRIFT AND SILT	LSUM	1.00
31379(04) PAY QUANTITIES			
0209 BRIDGE 'J' - NBI 30017 - SH-102 OVER NORTH CANADIAN RIVER			
ITEM	DESCRIPTION	UNIT	QUANTITY
201	6215 (PL) REMOVE DRIFT AND SILT	LSUM	1.00

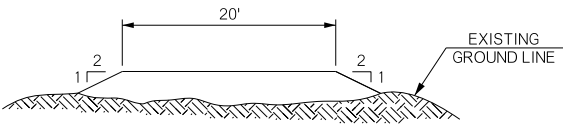

TYPICAL SECTION THROUGH WORK ROAD

HAZARDOUS MATERIALS (CON'T):

ANY SUCH CONDITIONS SHALL BE REPORTED IMMEDIATELY TO THE RESIDENT ENGINEER, WHO MAY CONTACT ENVIRONMENTAL PROGRAMS DIVISION FOR ASSISTANCE AT (405) 521-3050. IF REMOVAL OF THESE ITEMS IS NECESSARY, DISPOSAL AT A PERMITTED SANITARY LANDFILL MAY BE REQUIRED.

FOR TYPICAL STORM DEBRIS THAT DOES NOT APPEAR TO CONTAIN POTENTIALLY HAZARDOUS MATERIALS, IT IS RECOMMENDED THAT THE MATERIAL BE MANAGED IN ACCORDANCE WITH FEDERAL GUIDANCE, INCLUDING BUT NOT LIMITED TO "FEDERAL EMERGENCY MANAGEMENT AGENCY (FEMA) DOCUMENT FEMA-325, PUBLIC ASSISTANCE, DEBRIS MANAGEMENT GUIDE, JULY, 2007".

REVISIONS		
REV. NO.	DESCRIPTION	DATE
1	OMITTED BRIDGE 'G'	8/15/16
2	REVISED ENVIRONMENTAL MITIGATION NOTES	8/24/16

DIV. 3 BRIDGE DRIFT/DEBRIS REMOVAL MULTIPLE COUNTY			Design	N/A	N/A
GENERAL NOTES AND SUMMARY OF PAY QUANTITIES (BRIDGE)			Detail	BB	5/16
			Check	RS	6/16
			Squad	SHAO	
			Engr:	SISON	
STATE OF OKLAHOMA		DEPARTMENT OF TRANSPORTATION			
JOB/PIECE NO. 31379 (04)		SHEET NO. AB01			

REVISIONS		
REV. NO.	DESCRIPTION	DATE

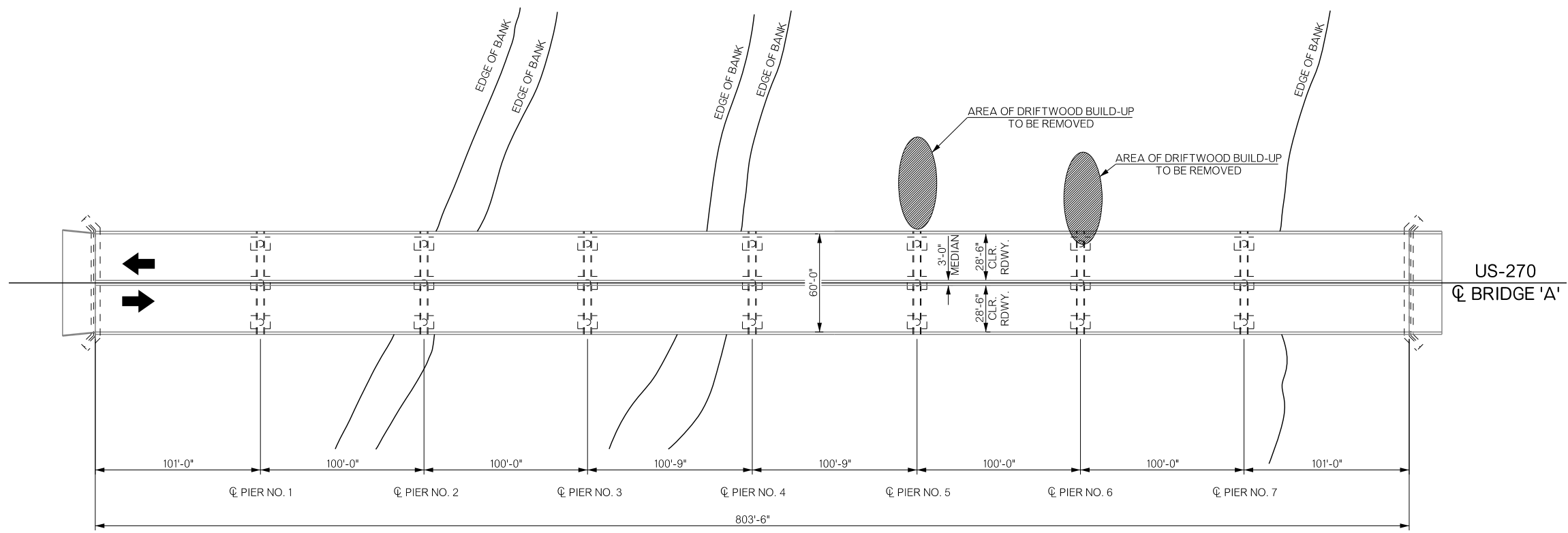

PLAN

(BASE BID)

SUMMARY		
31379(04) BRIDGE 'A': US-270 OVER NORTH CANADIAN RIVER		
DESCRIPTION	UNIT	QUANTITY
REMOVE DRIFT AND SILT	C.Y.	5,600.00

BRIDGE "A" US-270 OVER N. CANADIAN RIVER	POTTAWATOMIE COUNTY		
	Design	N/A	N/A
LAYOUT OF DRIFTWOOD REMOVAL	Detail	DSV	05/16
	Check	BAB	06/16
	Squad	SHAO	
	Engr.	SISON	
STATE OF OKLAHOMA	DEPARTMENT OF TRANSPORTATION		
JOB/PIECE NO.	31379(04)	SHEET NO.	B001

REVISIONS		
REV. NO.	DESCRIPTION	DATE

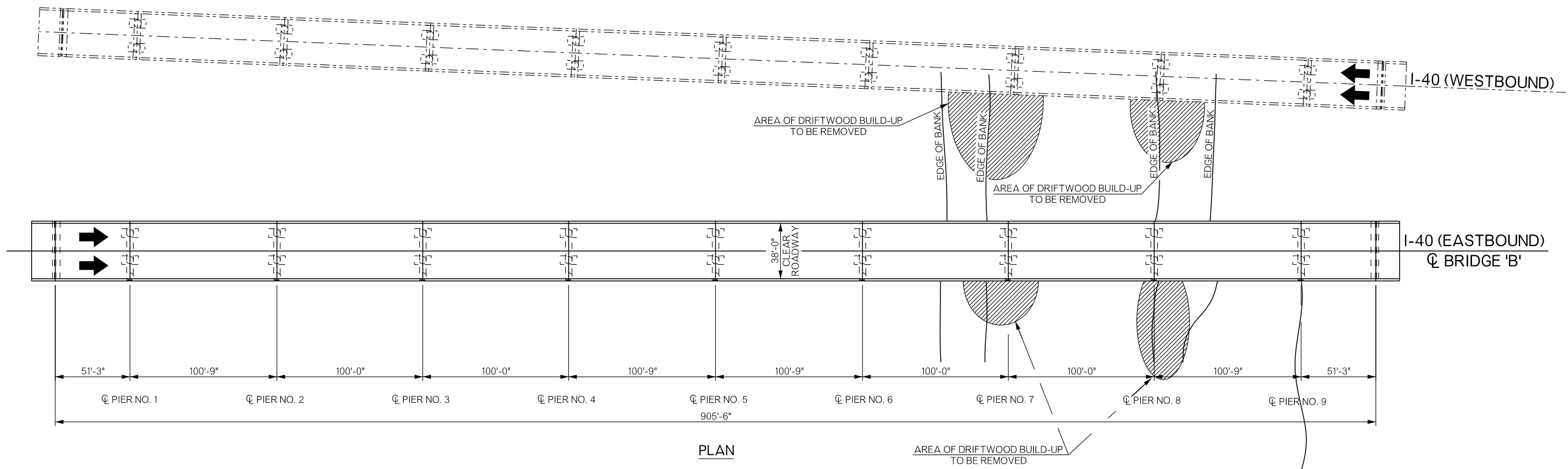

(BASE BID)

SUMMARY		
BRIDGE 'B': I-40 EB. OVER NORTH CANADIAN RIVER		
DESCRIPTION	UNIT	QUANTITY
REMOVE DRIFT AND SILT	C.Y.	9,000.00

BRIDGE "B" I-40 EB. OVER NORTH CANADIAN RIVER	POTTAWATOMIE COUNTY		Design	N/A	N/A
	LAYOUT OF DRIFTWOOD REMOVAL		Detail	DSV	05/16
			Check	BAB	06/16
		Squad: SHAO			
		Engr: SISON			
STATE OF OKLAHOMA	DEPARTMENT OF TRANSPORTATION				
JOBPIECE NO.	31379(04)	SHEET NO.		B002	

REVISIONS		
REV. NO.	DESCRIPTION	DATE

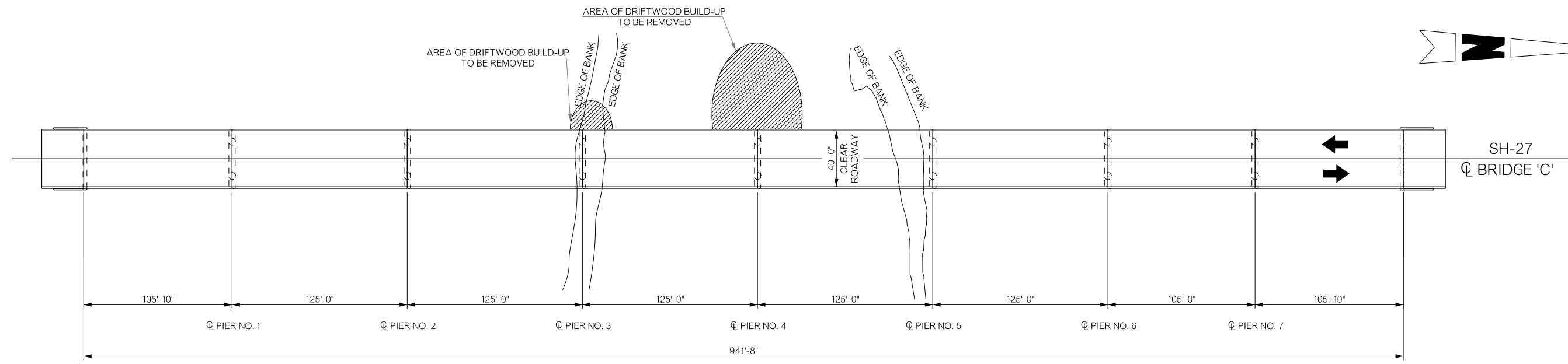

PLAN

(BASE BID)
31379(04)

SUMMARY		
BRIDGE 'C': SH-27 OVER N. CANADIAN RIVER		
DESCRIPTION	UNIT	QUANTITY
REMOVE DRIFT AND SILT	C.Y.	10,000.00

BRIDGE "C" SH-27 OVER NORTH CANADIAN RIVER	OKFUSKEE COUNTY	Design	N/A	N/A
LAYOUT OF DRIFTWOOD REMOVAL		Detail	DSV	05/16
		Check	BAB	06/16
STATE OF OKLAHOMA		Squad: SHAO	Engr: SISON	
DEPARTMENT OF TRANSPORTATION		JOB/PIECE NO. 31379(04)	SHEET NO. B003	

REVISIONS		
REV. NO.	DESCRIPTION	DATE

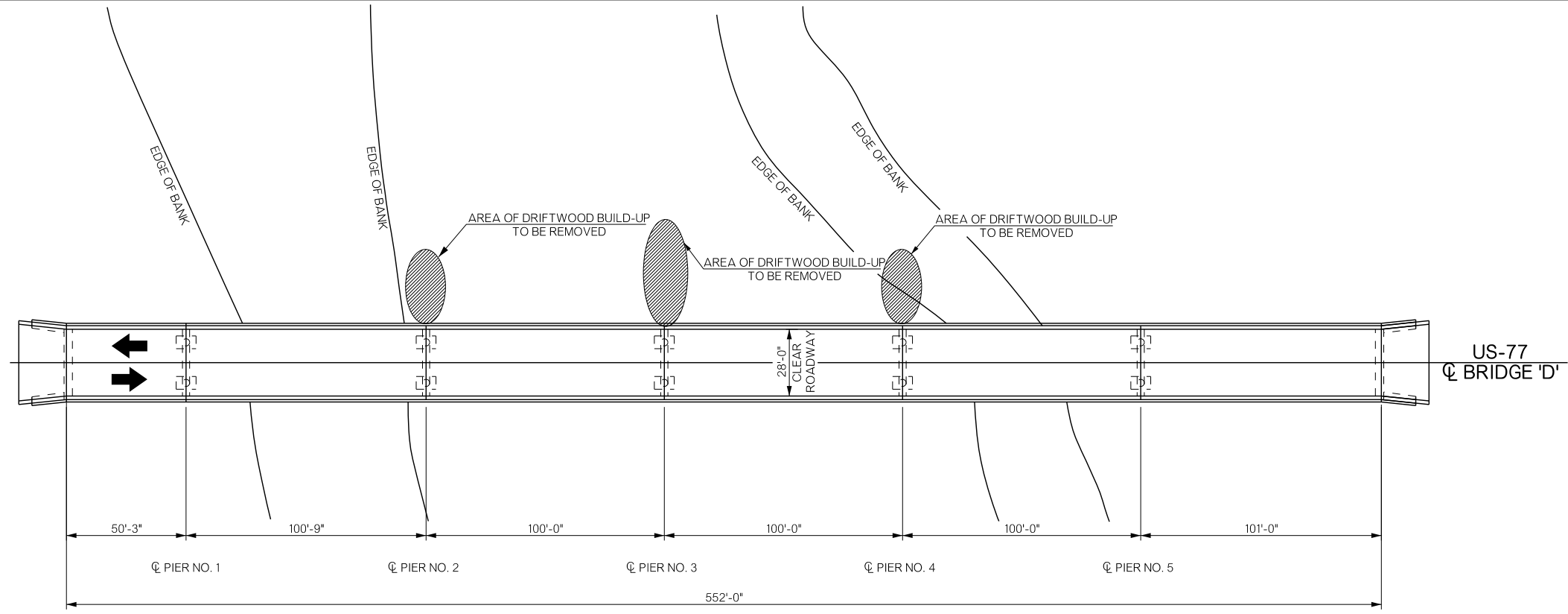

PLAN

(BASE BID)
31379(04)

SUMMARY		
BRIDGE 'D': US-77 OVER WASHITA RIVER		
DESCRIPTION	UNIT	QUANTITY
REMOVE DRIFT AND SILT	C.Y.	8,000.00

BRIDGE "D" US-77 OVER WASHITA RIVER LAYOUT OF DRIFTWOOD REMOVAL	GARVIN COUNTY		Design	N/A	N/A
			Detail	DSV	05/16
			Check	BAB	06/16
			Squad	SHAO	
		Engr:	SISON		
STATE OF OKLAHOMA	DEPARTMENT OF TRANSPORTATION		JOB/PIECE NO.	31379(04)	
			SHEET NO.	B004	

REVISIONS		
REV. NO.	DESCRIPTION	DATE

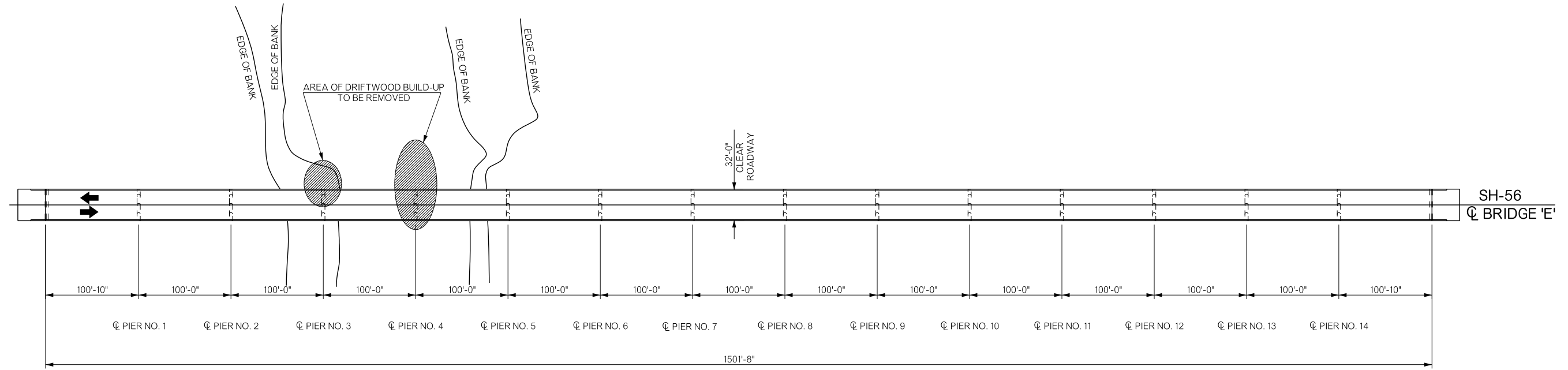

PLAN

(BASE BID)
31379(04)

SUMMARY		
BRIDGE 'E': SH-56 OVER NORTH CANADIAN		
DESCRIPTION	UNIT	QUANTITY
REMOVE DRIFT AND SILT	C.Y.	6,700.00

BRIDGE "E" SH-56 OVER NORTH CANADIAN RIVER	OKFUSKEE COUNTY		Design	N/A	N/A
	LAYOUT OF DRIFTWOOD REMOVAL		Detail	DSV	05/16
			Check	BAB	06/16
STATE OF OKLAHOMA		DEPARTMENT OF TRANSPORTATION	Squad: SHAO	Engr: SISON	
JOBPIECE NO. 31379(04)		SHEET NO. B005			

REVISIONS		
REV. NO.	DESCRIPTION	DATE

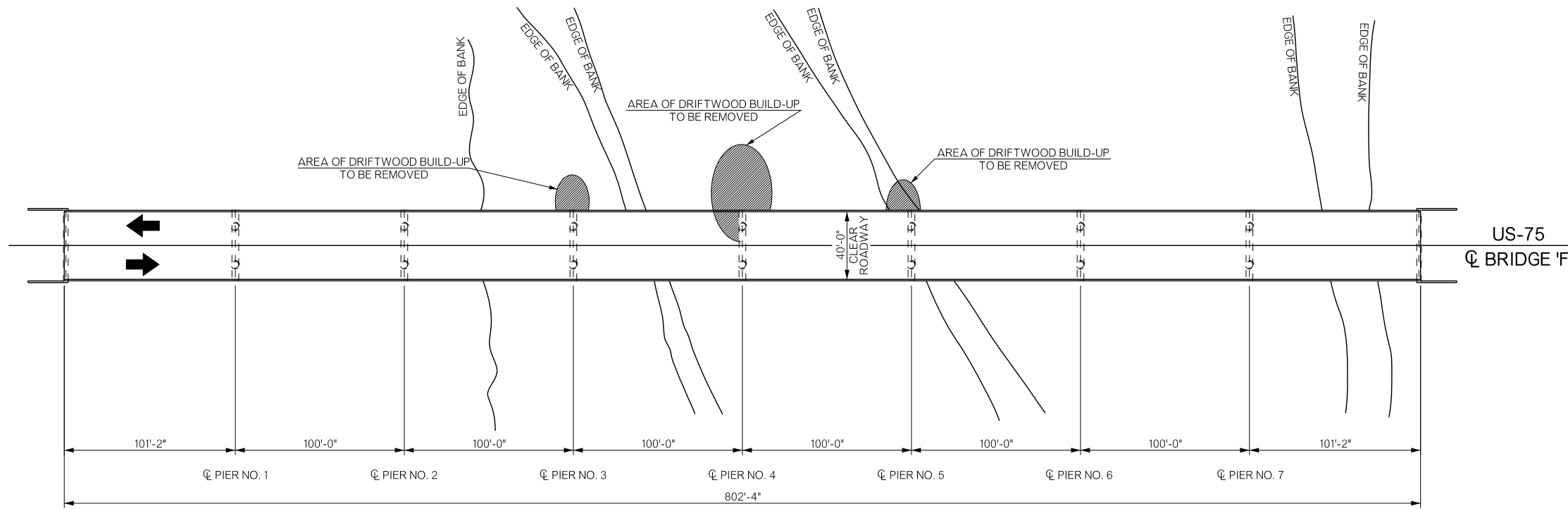

PLAN

(ADD ALTERNATE)

SUMMARY		
BRIDGE 'F': US-75 OVER NORTH CANADIAN RIVER		
DESCRIPTION	UNIT	QUANTITY
REMOVE DRIFT AND SILT	C.Y.	3,000.00

BRIDGE 'F' US-75 OVER NORTH CANADIAN RIVER	HUGHES COUNTY		Design	N/A	N/A
	LAYOUT OF DRIFTWOOD REMOVAL		Detail	DSV	05/16
			Check	BAB	06/16
STATE OF OKLAHOMA			Squad: SHAO	Engr: SISON	
DEPARTMENT OF TRANSPORTATION		JOB/PIECE NO. 31379(04)	SHEET NO. B006		

REVISIONS		
REV. NO.	DESCRIPTION	DATE

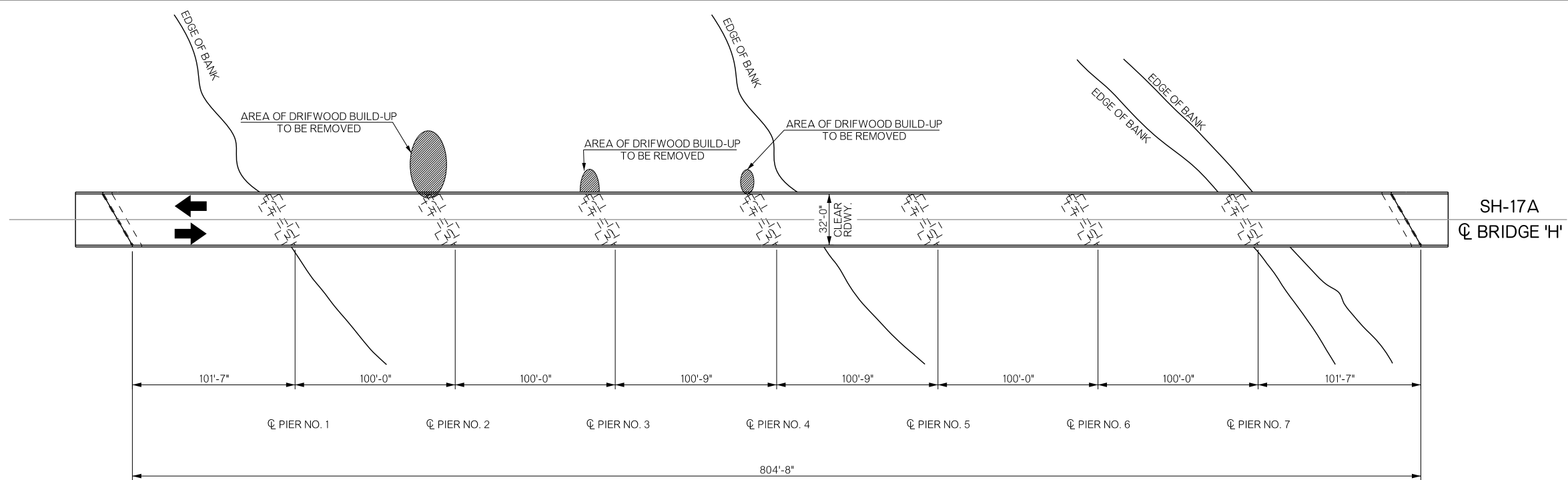

PLAN

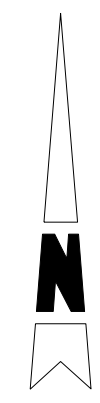

(ADD ALTERNATE)

SUMMARY		
BRIDGE 'H': SH-17A OVER WASHITA RIVER		
DESCRIPTION	UNIT	QUANTITY
REMOVE DRIFT AND SILT	C.Y.	1,600.00

BRIDGE "H" SH-17A OVER WASHITA RIVER LAYOUT OF DRIFTWOOD REMOVAL	GARVIN COUNTY		Design	N/A	N/A
			Detail	DSV	03/16
			Check	BAB	06/16
			Squad	SHAO	
		Engr:	SISON		
STATE OF OKLAHOMA	DEPARTMENT OF TRANSPORTATION				
JOB/PIECE NO.	31379(04)			SHEET NO.	B008

REVISIONS		
REV. NO.	DESCRIPTION	DATE

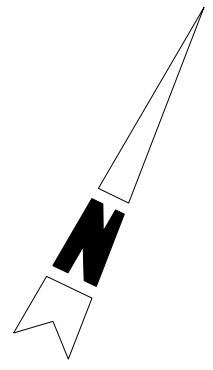
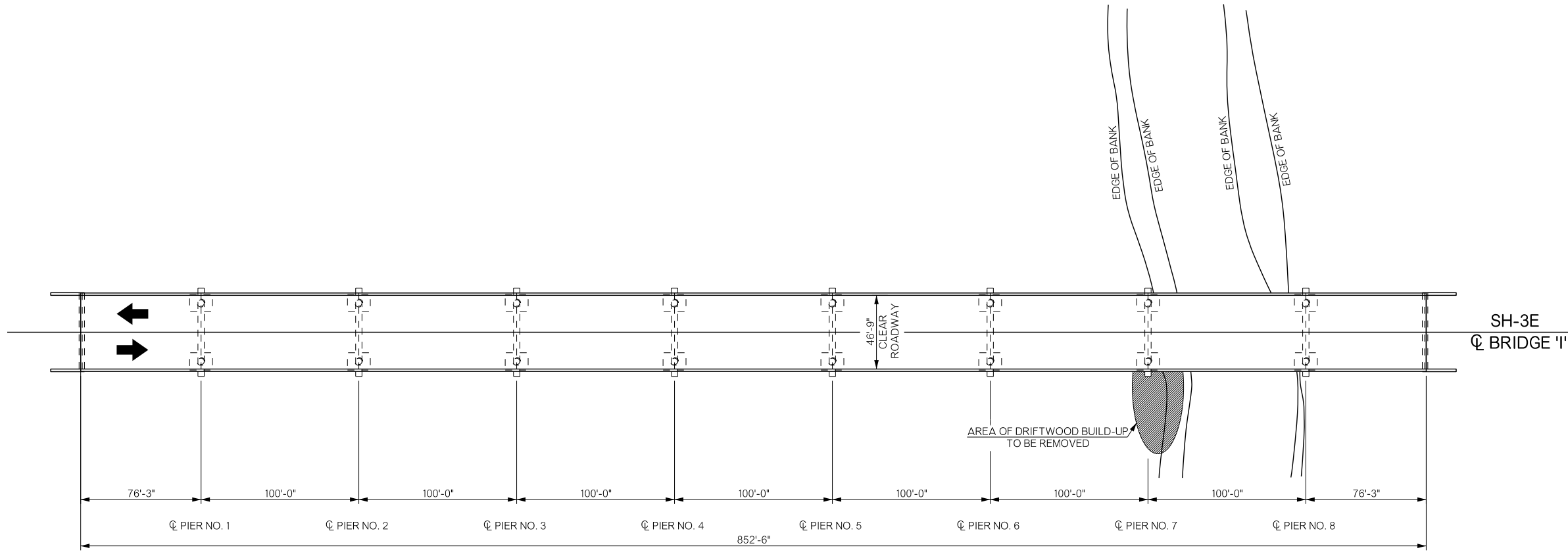

PLAN

(ADD ALTERNATE)

SUMMARY		
BRIDGE 'I': SH-3E OVER NORTH CANADIAN RIVER		
DESCRIPTION	UNIT	QUANTITY
REMOVE DRIFT AND SILT	C.Y.	1,670.00

BRIDGE 'I' SH-3E OVER NORTH CANADIAN RIVER	POTTAWATOMIE COUNTY		Design	N/A	N/A
	LAYOUT OF DRIFTWOOD REMOVAL		Detail	DSV	05/16
			Check	BAB	06/16
			Squad	SHAO	
			Engr.	SISON	
STATE OF OKLAHOMA	DEPARTMENT OF TRANSPORTATION		JOB/PIECE NO.	31379(04)	
			SHEET NO.	B009	

REVISIONS		
REV. NO.	DESCRIPTION	DATE

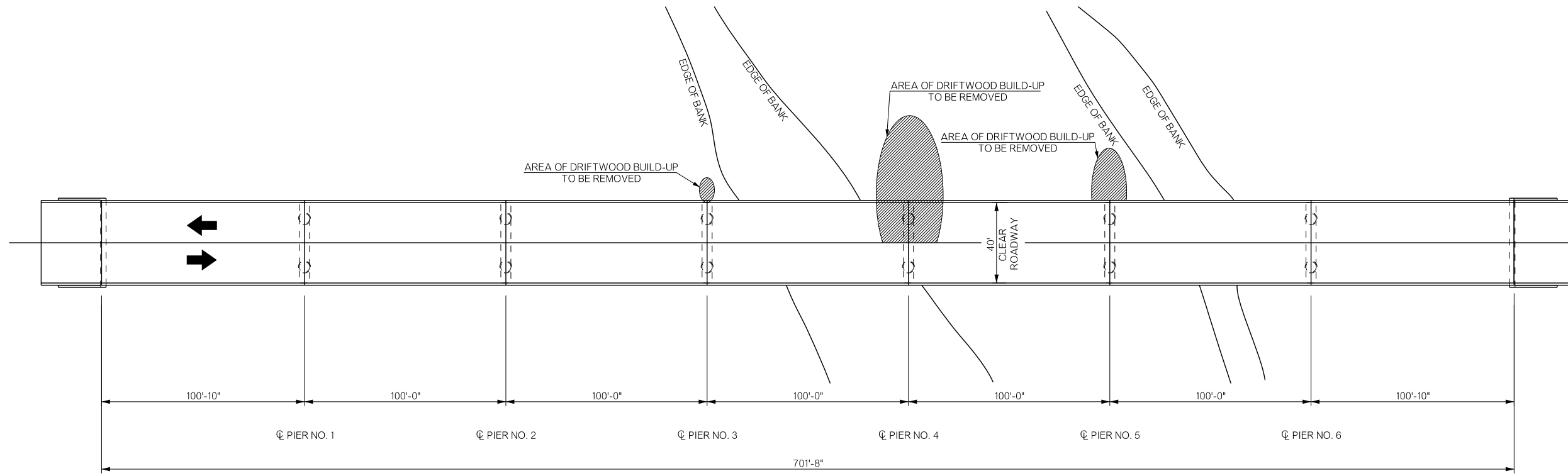

SH-102
 ☉ BRIDGE 'J'

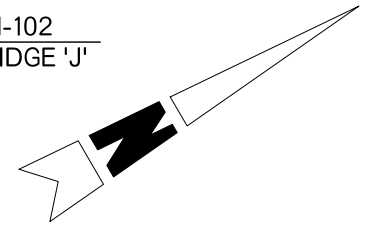

PLAN

(ADD ALTERNATE)

SUMMARY		
BRIDGE 'J': SH-102 OVER NORTH CANADIAN RIVER		
DESCRIPTION	UNIT	QUANTITY
REMOVE DRIFT AND SILT	C.Y.	1,350.00

BRIDGE "J" SH-102 OVER N. CANADIAN RIVER	POTTAWATOMIE COUNTY		Design	N/A	N/A
	LAYOUT OF DRIFTWOOD REMOVAL		Detail	DSV	05/16
			Check	BAB	06/16
			Squad	SHAO	
			Engr.	SISON	
STATE OF OKLAHOMA	DEPARTMENT OF TRANSPORTATION		JOB/PIECE NO.	31379(04)	
			SHEET NO.	B010	